

# HENCOFLOOR STEEL MESH

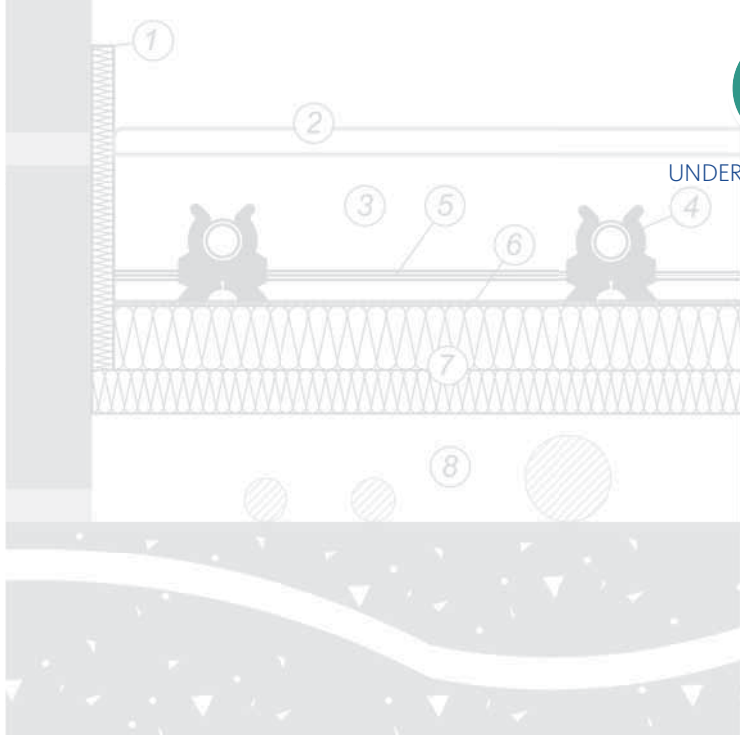

UNDERFLOOR HEATING

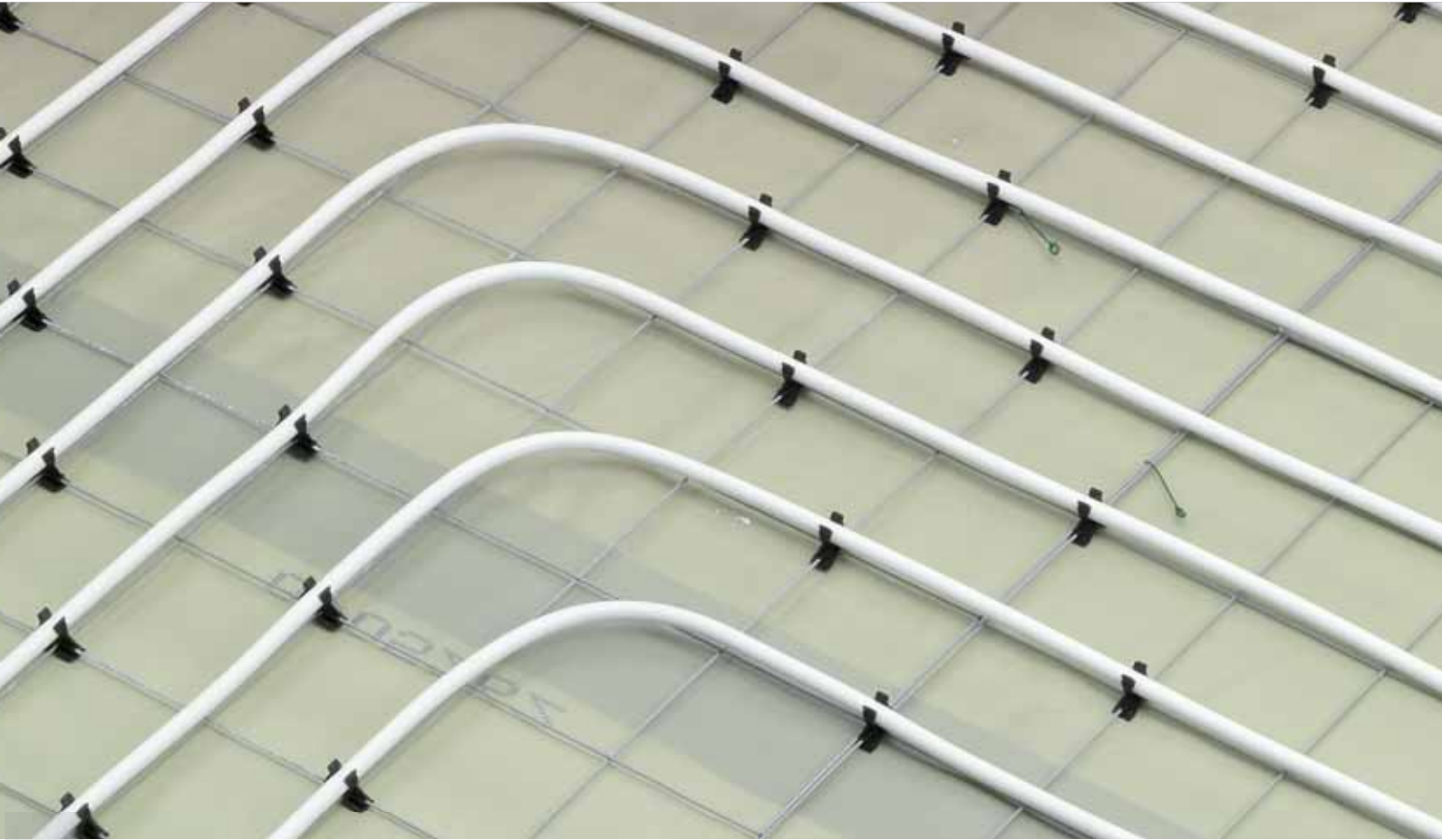

FLOOR



## Why Hencofloor?

Hencofloor offers a comprehensive range of high-quality products, spearheaded by the Henco multilayer pipe.

The installation of a long-lasting high-quality pipe is of the utmost importance for an underfloor heating system. After all, it is expensive to replace the piping system.

In addition to this range of top-class products, Hencofloor boasts an experienced and customer-friendly design office, guaranteeing the necessary support on all levels.

- ▶ Expert technical advice
- ▶ Detailed scale plans for the installation
- ▶ Technical file, complete underfloor heating calculation
- ▶ Own engineering insurance
- ▶ Close follow-up in consultation with all the parties involved

All this makes Hencofloor the best partner for your underfloor heating project.

## Advantages of underfloor heating

- ▶ The ideal combination with energy-efficient heating applications, such as e.g. heat pumps, solar boilers, ...
- ▶ A significant energy cost reduction compared to other heating systems
- ▶ The agreeable warmth perfectly meets human needs
- ▶ Radiators are superfluous, as a result of which the room can be fully used
- ▶ Unaesthetic heating elements are thing of the past
- ▶ Unhygienic dust cannot accumulate anywhere, unlike conventional heating.



## Henco multilayer pipe



### The HENCO multilayer pipe has all the advantages of metal and plastic

- ▶ Seamlessly butt-welded aluminium pipe
- ▶ 100% oxygen-tight
- ▶ Limited linear expansion coefficient, like metal
- ▶ Completely resistant to corrosion and chemical and electrochemical influences
- ▶ Sound-damping, like plastic pipes
- ▶ Inner and outer pipes made from cross-linked polyethylene
- ▶ High pressure and temperature resistance
- ▶ Smooth surface – limited pressure loss
- ▶ As light as plastic pipes
- ▶ Flexible, easy to bend, even at low temperatures, retains its curved shape

## Hencofloor steel mesh

This is an underfloor heating system in which the pipe is mounted on a steel mesh by means of clips or binding wire. The steel mesh is available with grids of 15 x 15 cm and 10 cm x 10 cm.

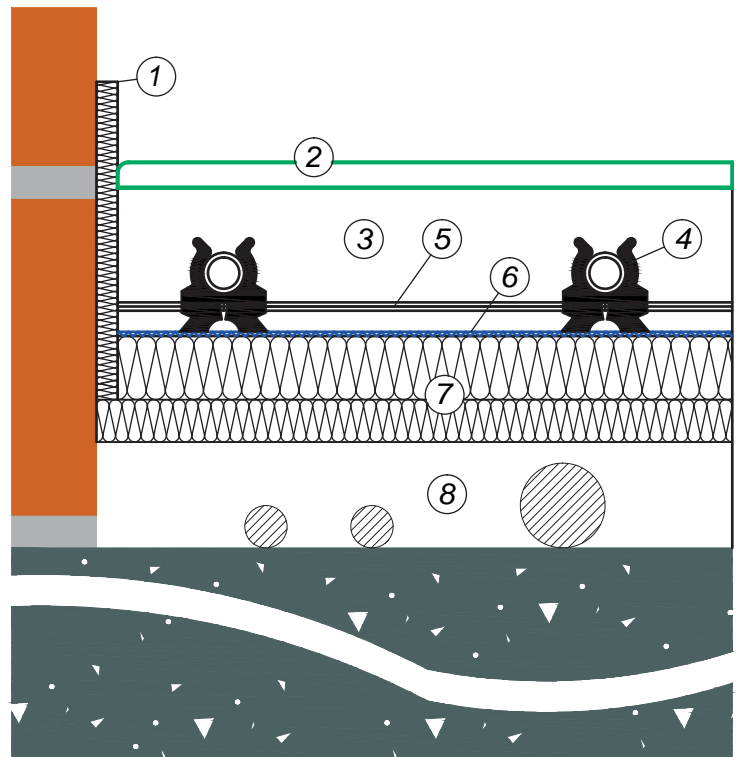

- |   |                         |
|---|-------------------------|
| 1 Edge insulation                             | 5 Steel mesh            |
| 2 Floor finish                                | 6 Vapour barrier        |
| 3 Screed                                      | 7 Flat insulation board |
| 4 Underfloor heating pipe with fastening clip | 8 Concrete slab         |

## Hencofloor steel mesh system components

ARTICLE NUMBER	DESCRIPTION
UFH-RAS10	steel mesh with 10 cm grid
UFH-RAS15	steel mesh with 15 cm grid
UFH-RAS-RB3	connecting clip for steel meshes
UFH-RAS-CLIP16	plastic clip for 16 mm pipe
UFH-RAS-CLIP18	plastic clip for 17 mm or 18 mm pipe
UFH-RAS-CLIP20	plastic clip for 20 mm pipe
UFH-RAS-BIND15B	steel plaiting wire of 160 mm for all pipe diameters
UFH-ISO20	flat insulation board of 20 mm ( <b>MAZE-2.....6</b> )
UFH-ISO30	flat insulation board of 30 mm ( <b>MAZE-2.....6</b> )
UFH-FOIL-N	PE foil
UFH-ISOBBOARD	edge insulation
UFH-DH40	joint protection sleeve
UFH-ADN10	additive for sand-cement screed
UFH-DP200	expansion joint
UFH-PLUG80	assembly plug for flat insulation board

## Hencofloor manifolds

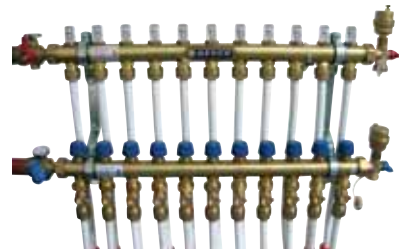

## Hencofloor control units



DESCRIPTION	UFH-ISO-20	UFH-ISO-30
Board size (mm)	1000 X 500	1000 X 500
Insulation thickness (mm)	20	30
Quality type	EPS 150	EPS 150
Flexural strength (kPa)	200	200
Compression strength 10% deformation (kPa)	150	150
Compression strength 3% deformation (kPa)	50	50
Compression strength max. 2% deformation (kPa)	40	40
Specific heat according to DIN 4108 (J/kg.K)	1470	1470
E-modulus according to DIN 53457 (kPa)	8000	8000
Temperature resistance (°C)	80	80
Water absorption cube 5/5/5 - 7 days	2,2 % VOL	2,2 % VOL
Water absorption cube 5/5/5 - 1 year (DIN 53457)	3,8 % VOL	3,8 % VOL
Density (kg/m³)	25	25
Thermal resistance (m²K/W)	0,55	0,85
Max. pressure load (kg/m²)	4000	4000
Packaging (pc.)	30	20

## Hencofloor systems



**MAZE steel mesh**  
system with steel meshes



**Tacker CLIP**  
system with tacker staples



**System plate PRO**  
pre-formed system plates



**Mounting profile U**  
system with mounting profiles



**OMEGA dry system**  
system for floor element construction

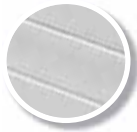

**RENO12**  
system for low construction heights

### STEEL MESH WITH CLIPS

MAZE K10	MAZE K15
MAZE K102	MAZE K152
MAZE K103	MAZE K153
MAZE K104	MAZE K154
MAZE K105	MAZE K155
MAZE K106	MAZE K156

### STEEL MESH WITH PLAITING

MAZE V10	MAZE V15
MAZE V102	MAZE V152
MAZE V103	MAZE V153
MAZE V104	MAZE V154
MAZE V105	MAZE V155
MAZE V106	MAZE V156

## Warranty

Henco has been awarded more than 50 quality certificates by renowned institutes all over the world. These certificates underpin the 10-year warranty included in every Hencofloor underfloor heating.

